

Double Flanged Cast Nylon 200mm Ball Bearing Wheel 1140kg Load

Product code: 200WNYDFBJM25

POA Double flanged Nylon wheel with ball bearings, wheel diameter 200mm, outer flange 240mm, flange width 60mm, total width 100mm, hub length 100mm, bore size 25mm load capacity 1140kg ****MANUFACTURED TO ORDER****

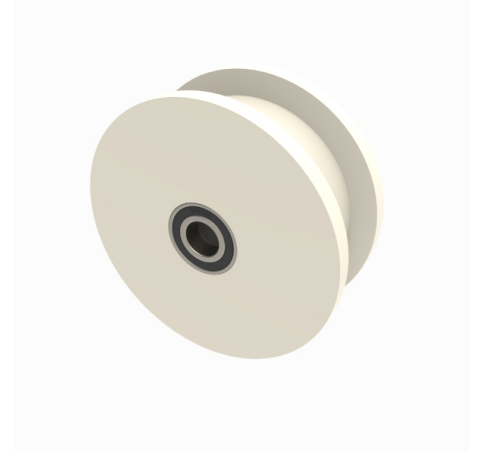

Wheel Material	Cast Nylon
Diameter (mm)	200
Flanged Diameter (mm)	240
Flange Width (mm)	60
Total Width (mm)	100
Hub Width (mm)	100
Bore Size (mm)	25
Load Capacity (kg)	1140
Colour / Shore Hardness	White Cast Nylon / 60 - 90 Shore D
Bearing Type	Ball

BIL GROUP LTD

Porte Marsh Road, Calne, Wiltshire, SN11 9BW

Registered in England No: 2603821

VAT Reg: GB572705729

