

## Double Flanged Cast Nylon 250mm Ball Bearing Wheel 2040kg Load

**Product code: 250WNYDFBJM30**

**POA** Double flanged Nylon wheel with ball bearings, wheel diameter 250mm, outer flange 295mm, flange width 60mm, total width 100mm, hub length 100mm, bore size 30mm. Load capacity 2040kg **\*\*MANUFACTURED TO ORDER\*\***

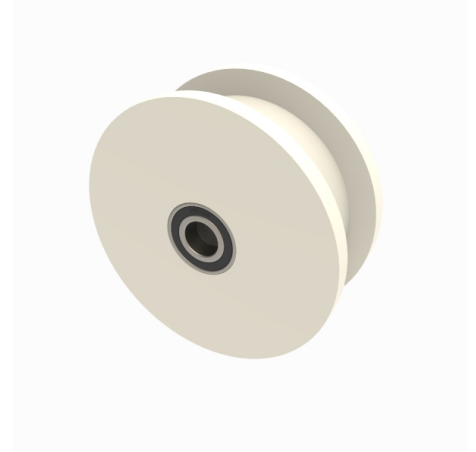

Wheel Material	Cast Nylon
Diameter (mm)	250
Flanged Diameter (mm)	295
Flange Width (mm)	60
Total Width (mm)	100
Hub Width (mm)	100
Bore Size (mm)	30
Load Capacity (kg)	2040
Colour / Shore Hardness	White Cast Nylon / 60 - 90 Shore D
Bearing Type	Ball

### BIL GROUP LTD

Porte Marsh Road, Calne, Wiltshire, SN11 9BW

Registered in England No: 2603821

VAT Reg: GB572705729

