

Nylon - High Temp 200mm Plain Bearing Wheel 900kg Load

Product code: BZH200WNY/130

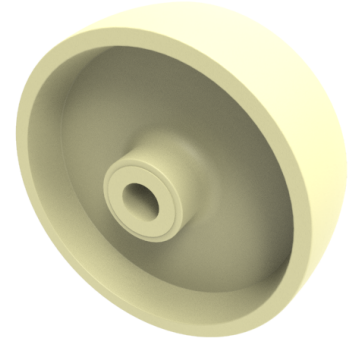

Fibre glass filled cream colour nylon (polamide 6) wheel with a 20mm plain bearing. Wheel diameter 200mm, tread width 50mm. Load capacity 900kg, at 150C

| | |
|-------------------------|------------------------------|
| Wheel Material | Nylon |
| Diameter (mm) | 200 |
| Load Capacity (kg) | 900 |
| Bearing Type | Plain |
| Bore Size (mm) | 20 |
| Tread (mm) | 50 |
| Hub Width (mm) | 58 |
| Colour / Shore Hardness | White High Temperature Nylon |
| Temperature Resistance | -30 °C to +130 °C |

BIL GROUP LTD

Porte Marsh Road, Calne, Wiltshire, SN11 9BW

Registered in England No: 2603821

VAT Reg: GB572705729

