

Soft Blue Polyurethane Nylon 125mm Ball Bearing Wheel 300kg Load

Product code: BZH125WENPBJM20

Blue 82 shore hardness polyurethane tyred nylon centred ball bearing. Wheel diameter 125mm, tread width 40mm, bore size 20mm, hub length 48mm. Load capacity 300kg.

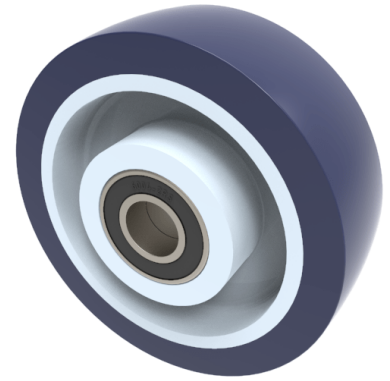

Bearing Type	Ball
Bore Size (mm)	20
Diameter (mm)	125
Hub Width (mm)	48
Load Capacity (kg)	300
Tread (mm)	40
Wheel Material	Polyurethane on Nylon
Colour / Shore Hardness	Blue Polyurethane on Nylon Rim / 82 Shore A
Temperature Resistance	-30 °C TO +70 °C

BIL GROUP LTD

Porte Marsh Road, Calne, Wiltshire, SN11 9BW

Registered in England No: 2603821

VAT Reg: GB572705729

