

DRAWING DISCLAIMER  
 COPYRIGHT OF THIS DRAWING IS RESERVED BY BIL GROUP LTD. IT IS ISSUED ON CONDITION THAT IT IS NOT REPRODUCED, COPIED, OR DISCLOSED TO A THIRD PARTY EITHER WHOLLY OR IN PART WITHOUT THE CONSENT IN WRITING OF BIL GROUP LTD.

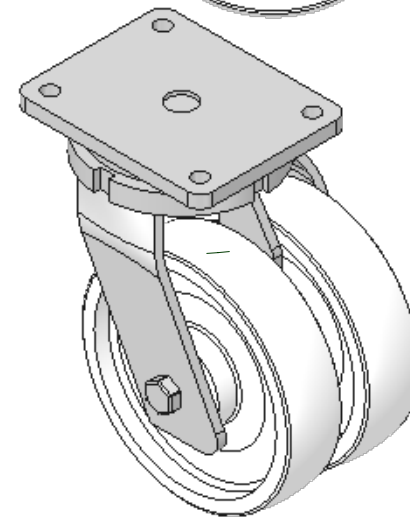

Description:  
 2BZQ200NYBJ

Twin wheeled swivel castor with a top plate fixing fitted with 2 white nylon wheels with ball journal bearings. Wheel diameter 2 x 200mm, tread width 2 x 50mm, overall height 264mm, top plate 175mm x 140mm, hole centres 140mm x 105. Load capacity 2000kg.

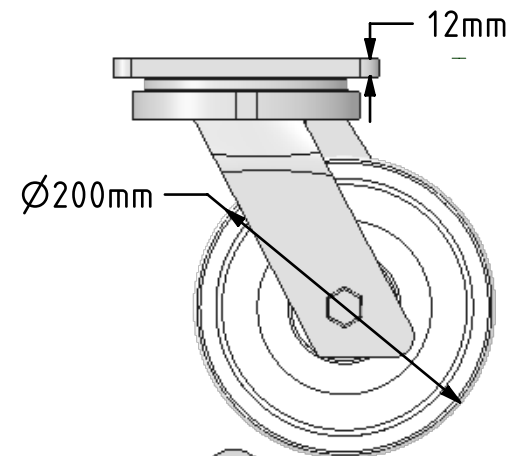
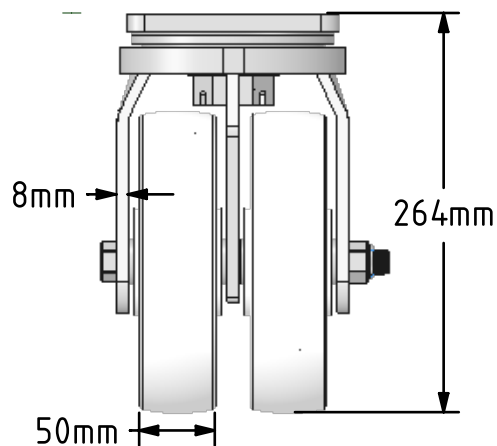
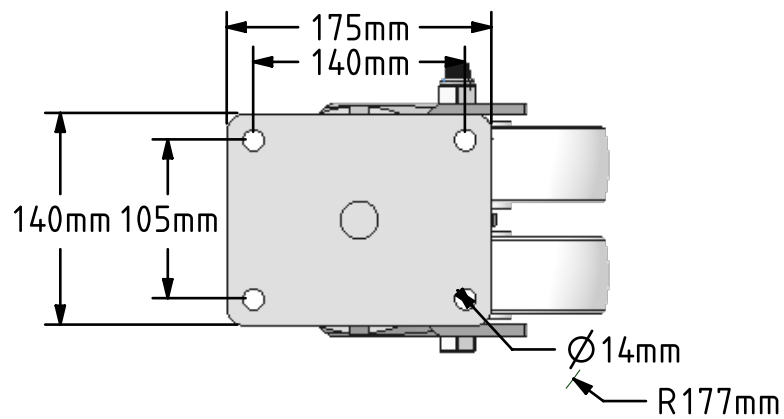

	NAME	DATE
DRAWN	Matt	31/05/18
APPROVED BY	Tim W	31/05/18
SCALE	1:5	31/05/18
WEIGHT	9.75kg	31/05/18

UNLESS OTHERWISE SPECIFIED DIMENSIONS ARE IN MILLIMETRES

Unspecified Tolerances  
 Machining ± 0.25mm  
 Fabrication ± 1mm



BIL Group Ltd, Porte Marsh Road, Calne  
 Wiltshire, SN11 9BW, United Kingdom  
 Tel +44 (0)1249 822 222 Fax: +44 (0)1249 822 300  
 www.bilgroup.co.uk

TITLE

2BZQ200NYBJ

SIZE	DWG NO.	REV
A4	BILCW032BZQ200NYBJ_01	1

FILE NAME BILCW032BZQ200NYBJ\_01.PDF SHEET 1 OF 1