

**DRAWING DISCLAIMER**  
 COPYRIGHT OF THIS DRAWING IS RESERVED BY BIL GROUP LTD. IT IS ISSUED ON CONDITION THAT IT IS NOT REPRODUCED, COPIED, OR DISCLOSED TO A THIRD PARTY EITHER WHOLLY OR IN PART WITHOUT THE CONSENT IN WRITING OF BIL GROUP LTD.

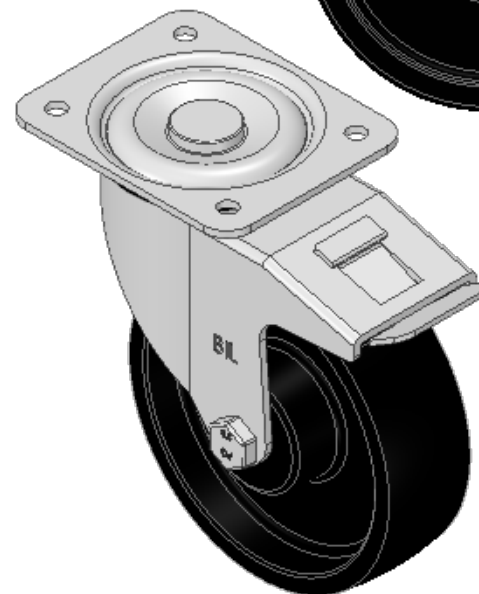

**Description:**  
 BZEH125CISWB

Pressed steel swivel castor with a top plate fixing fitted with a cast iron wheel with a plain bearing and a total lock brake. Wheel diameter 125mm, tread width 38mm, overall height 155mm, top plate 105mm x 86mm, hole centres 80mm x 60mm. Load capacity 300kg. Not high temp

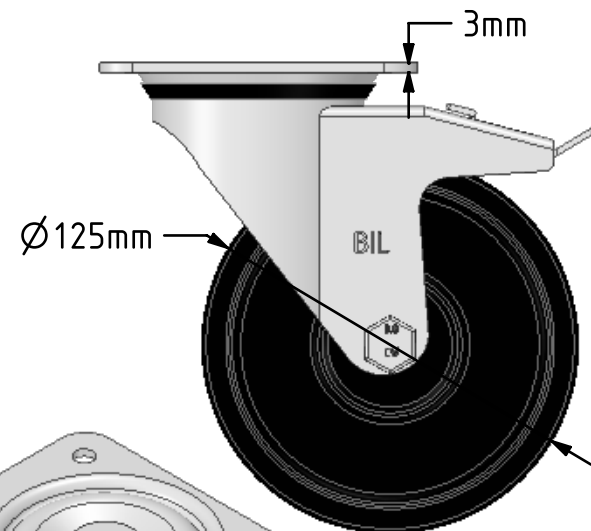
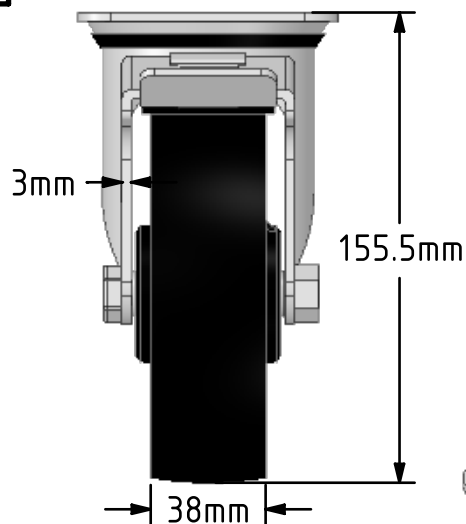
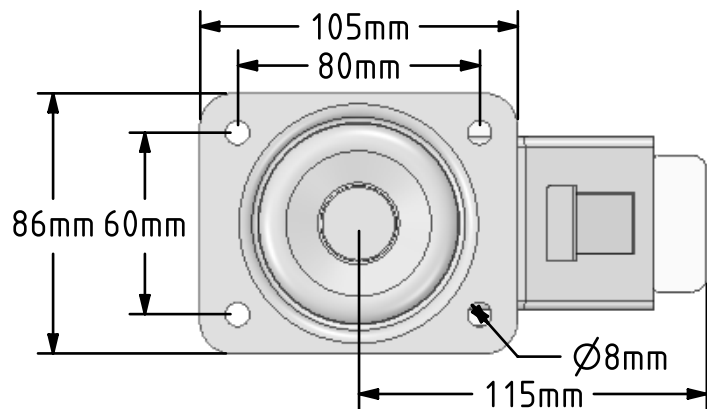

	NAME	DATE
DRAWN	Matt	22/03/19
APPROVED BY	Chris	22/03/19
SCALE	2:5	22/03/19
WEIGHT	2.666kg	22/03/19

UNLESS OTHERWISE SPECIFIED DIMENSIONS ARE IN MILLIMETRES

Unspecified Tolerances  
 Machining ± 0.25mm  
 Fabrication ± 1mm



BIL Group Ltd, Porte Marsh Road, Calne  
 Wiltshire, SN11 9BW, United Kingdom  
 Tel +44 (0)1249 822 222 Fax: +44 (0)1249 822 300  
 www.bilgroup.co.uk

TITLE

**BZEH125CISWB**

SIZE	DWG NO.	REV
A4	BILCW03BZEH125CISWB_02	2

FILE NAME BILCW03BZEH125CISWB\_02.PDF SHEET 1 OF 1