

DRAWING DISCLAIMER
 COPYRIGHT OF THIS DRAWING IS RESERVED BY BIL GROUP LTD. IT IS ISSUED ON CONDITION THAT IT IS NOT REPRODUCED, COPIED, OR DISCLOSED TO A THIRD PARTY EITHER WHOLLY OR IN PART WITHOUT THE CONSENT IN WRITING OF BIL GROUP LTD.

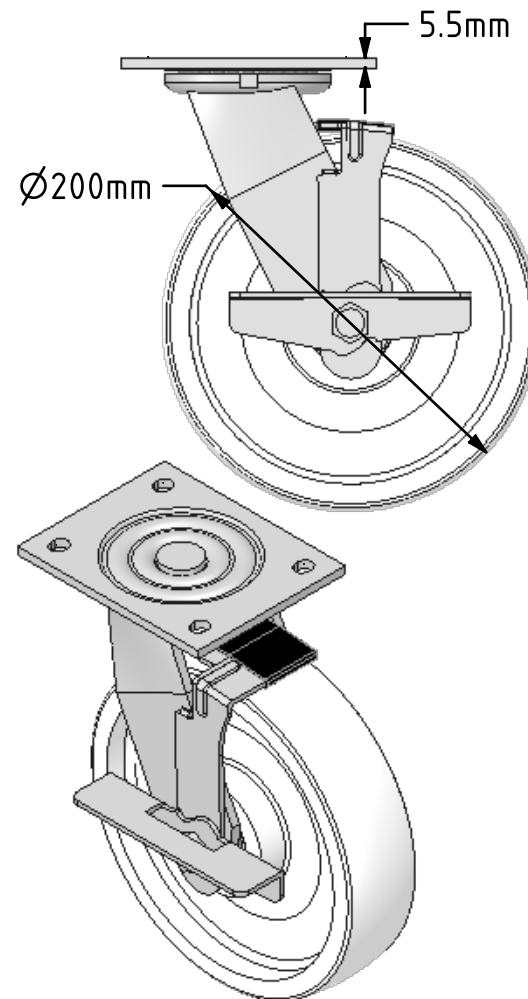

Description:
 BZJ200NYBJBK

Fabricated swivel castor with a top plate fixing fitted with a white nylon wheel with ball bearings and side fitting wheel brake. Wheel diameter 200mm, tread width 50mm, overall height 240mm, top plate 135mm x 110mm, hole centres 105mm x 80mm. Load capacity 600kg.

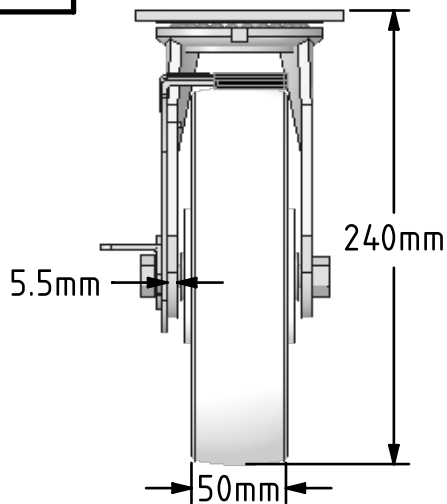
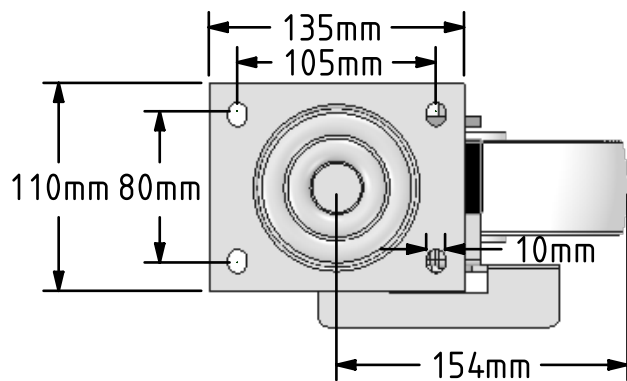

	NAME	DATE
DRAWN	Matt	27/03/18
APPROVED BY	Tim W	27/03/18
SCALE	1:4	27/03/18
WEIGHT	3.413kg	27/03/18

UNLESS OTHERWISE SPECIFIED DIMENSIONS ARE IN MILLIMETRES

Unspecified Tolerances
 Machining ± 0.25mm
 Fabrication ± 1mm



BIL Group Ltd, Porte Marsh Road, Calne
 Wiltshire, SN11 9BW, United Kingdom
 Tel +44 (0)1249 822 222 Fax: +44 (0)1249 822 300
 www.bilgroup.co.uk

TITLE

BZJ200NYBJBK

SIZE	DWG NO.	REV
A4	BILCW03BZJ200NYBJBK_01	1

FILE NAME BILCW03BZJ200NYBJBK_01.PDF SHEET 1 OF 1