

DRAWING DISCLAIMER  
 COPYRIGHT OF THIS DRAWING IS RESERVED BY BIL GROUP LTD. IT IS ISSUED ON CONDITION THAT IT IS NOT REPRODUCED, COPIED, OR DISCLOSED TO A THIRD PARTY EITHER WHOLLY OR IN PART WITHOUT THE CONSENT IN WRITING OF BIL GROUP LTD.

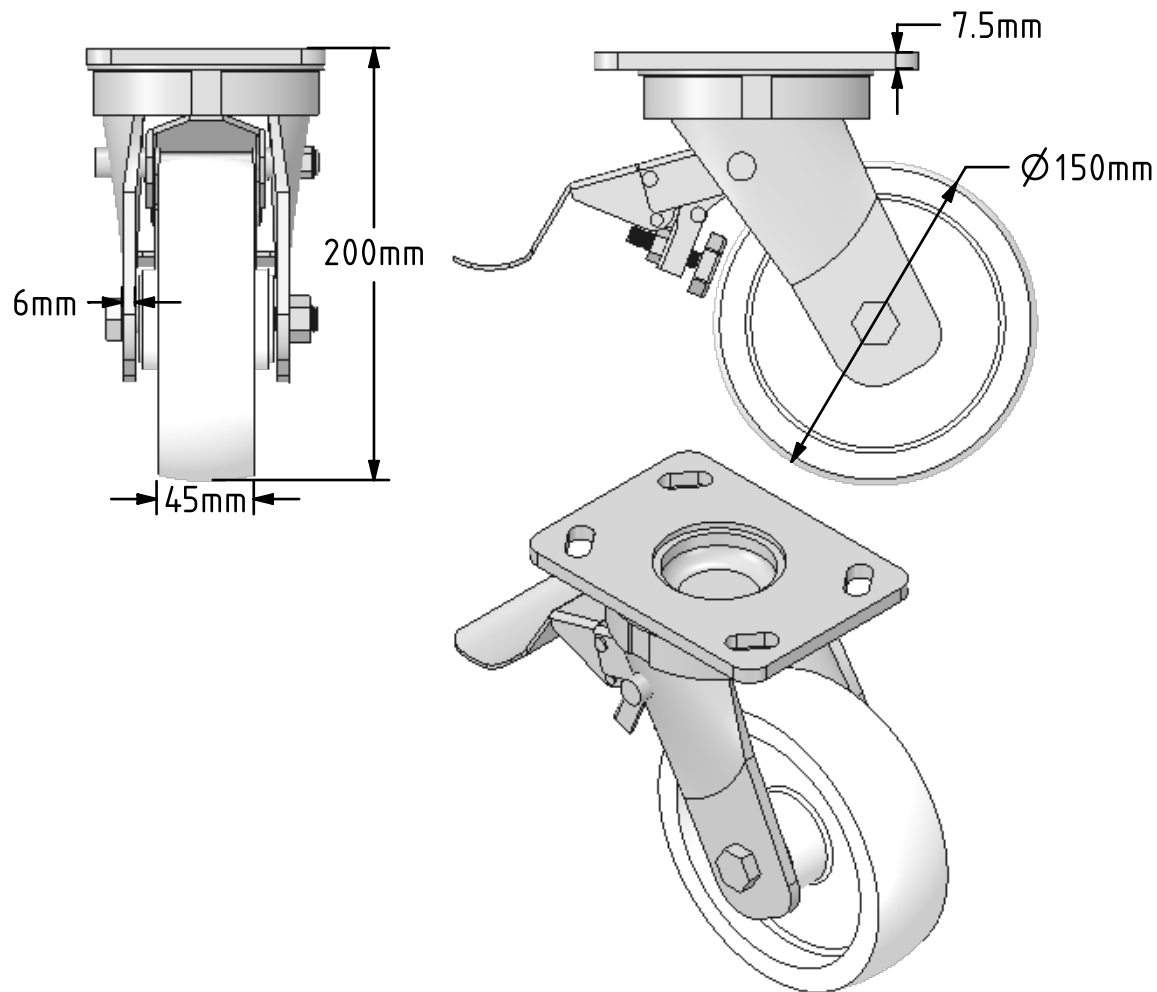

Description:  
 BZK150NYSWB

Fabricated swivel castor with a top plate fixing fitted with a white nylon wheel with plain bearing and total lock brake. Wheel diameter 150mm, tread width 45mm, overall height 200mm, top plate 150mm x 110mm, hole centres 105mm x 80mm or 121mm x 59mm. Load capacity 750kg.

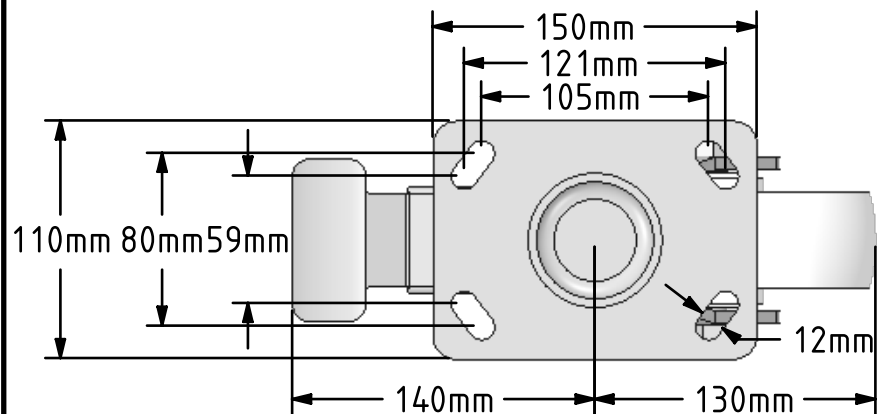

	NAME	DATE
DRAWN	Matt	09/03/18
APPROVED BY	Chris	09/03/18
SCALE	2:7	09/03/18
WEIGHT	4.106kg	09/03/18

UNLESS OTHERWISE SPECIFIED DIMENSIONS ARE IN MILLIMETRES

Unspecified Tolerances  
 Machining ± 0.25mm  
 Fabrication ± 1mm



BIL Group Ltd, Porte Marsh Road, Calne  
 Wiltshire, SN11 9BW, United Kingdom  
 Tel +44 (0)1249 822 222 Fax: +44 (0)1249 822 300  
 www.bilgroup.co.uk

TITLE

BZK150NYSWB

SIZE DWG NO.

A4

BILCW03BZK150NYSWB\_01

REV

1

FILE NAME

BILCW03BZK150NYSWB\_01.PDF

SHEET 1 OF 1