

DRAWING DISCLAIMER
 COPYRIGHT OF THIS DRAWING IS RESERVED BY BIL GROUP LTD. IT IS ISSUED ON CONDITION THAT IT IS NOT REPRODUCED, COPIED, OR DISCLOSED TO A THIRD PARTY EITHER WHOLLY OR IN PART WITHOUT THE CONSENT IN WRITING OF BIL GROUP LTD.

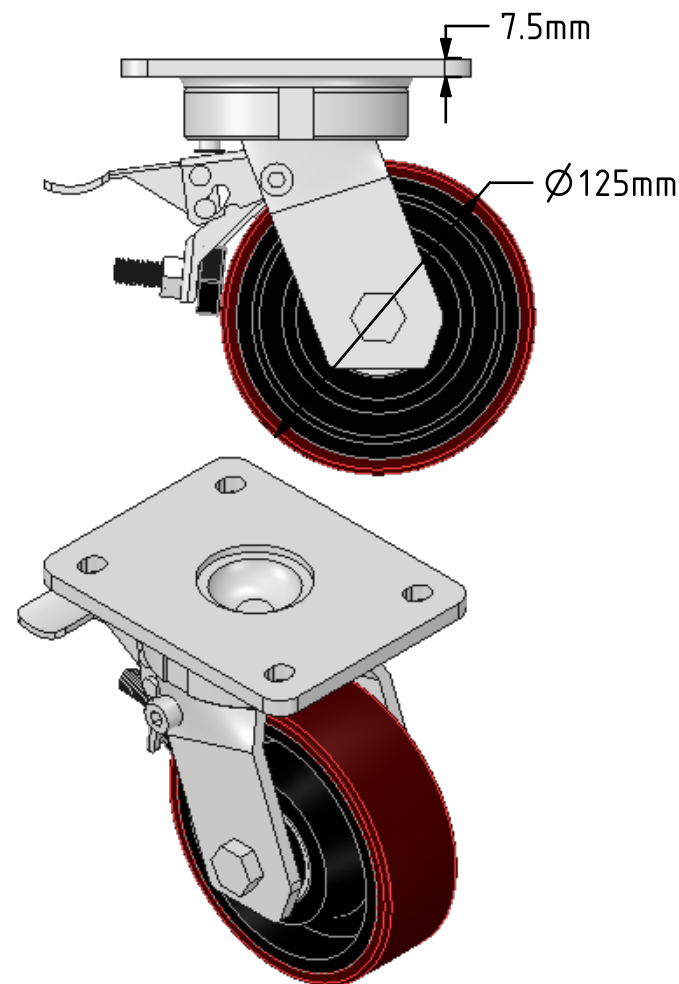

Description:
 BZKL125PTBJSWB

Fabricated swivel castor with a top plate fixing fitted with a polyurethane on cast iron centred wheel with ball journal bearings and total lock brake. Wheel diameter 125mm, tread width 40mm, overall height 165mm, top plate 138mm x 110mm, hole centres 105mm x 80/75mm. Load capacity 400kg.

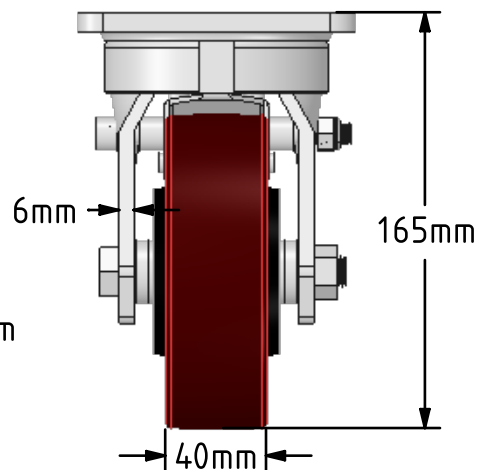
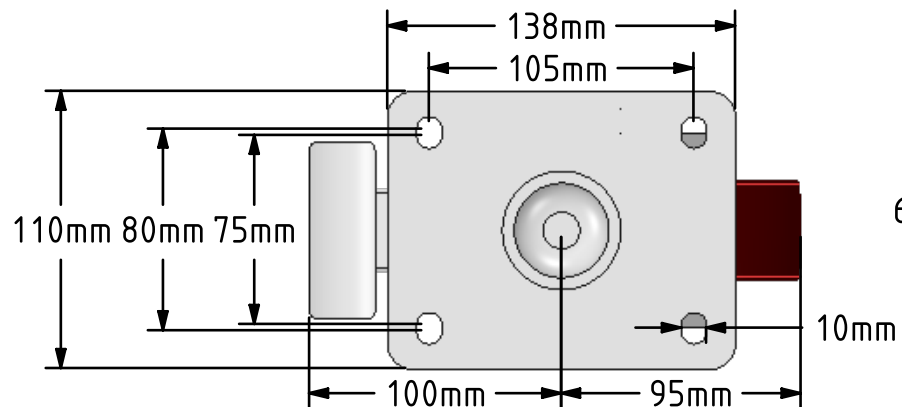

	NAME	DATE
DRAWN	Matt	13/12/17
APPROVED BY	Tim W	13/12/17
SCALE	1:3	13/12/17
WEIGHT	4.592kg	13/12/17

UNLESS OTHERWISE SPECIFIED DIMENSIONS ARE IN MILLIMETRES

Unspecified Tolerances
 Machining ± 0.25mm
 Fabrication ± 1mm



BIL Group Ltd, Porte Marsh Road, Calne
 Wiltshire, SN11 9BW, United Kingdom
 Tel +44 (0)1249 822 222 Fax: +44 (0)1249 822 300
 www.bilgroup.co.uk

TITLE

BZKL125PTBJSWB

SIZE	DWG NO.	REV
A4	BILCW03BZKL125PTBJSWB_01	1

FILE NAME BILCW03BZKL125PTBJSWB_01.PDF SHEET 1 OF 1