

DRAWING DISCLAIMER
 COPYRIGHT OF THIS DRAWING IS RESERVED BY BIL GROUP LTD. IT IS ISSUED ON CONDITION THAT IT IS NOT REPRODUCED, COPIED, OR DISCLOSED TO A THIRD PARTY EITHER WHOLLY OR IN PART WITHOUT THE CONSENT IN WRITING OF BIL GROUP LTD.

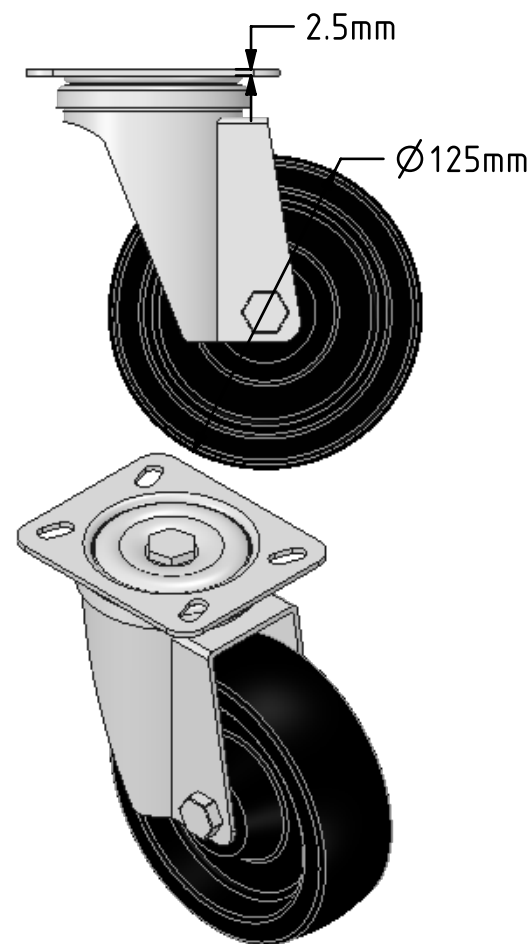

Description:
 BZMH125AN3

Pressed steel swivel castor with a top plate fixing fitted with a Ditherm wheel with plain bore. Wheel diameter 125mm, tread width 40mm, overall height 158mm, top plate 100mm x 85mm, hole centres 80mm x 60mm. Load capacity 200kg. 300 C. REACH compliant, RoHS Compliant, USDA approved FDA approved.

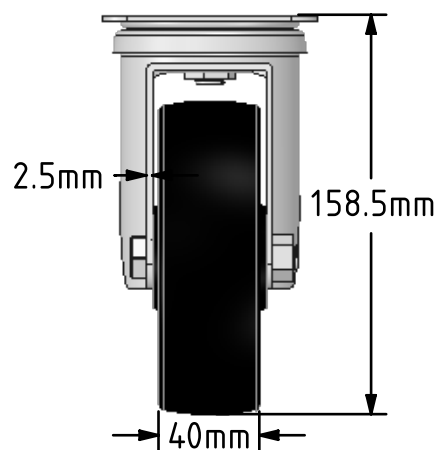
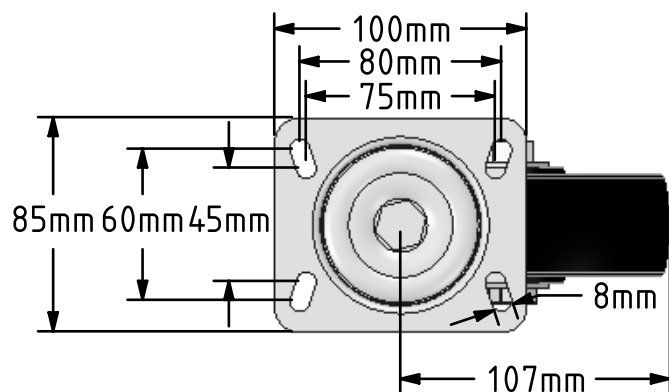

	NAME	DATE
DRAWN	Matt	30/11/17
APPROVED BY	Tim W	30/11/17
SCALE	1:3	30/11/17
WEIGHT	1.282kg	30/11/17

UNLESS OTHERWISE SPECIFIED DIMENSIONS ARE IN MILLIMETRES

Unspecified Tolerances
 Machining ± 0.25mm
 Fabrication ± 1mm



BIL Group Ltd, Porte Marsh Road, Calne
 Wiltshire, SN11 9BW, United Kingdom
 Tel +44 (0)1249 822 222 Fax: +44 (0)1249 822 300
 www.bilgroup.co.uk

TITLE

BZMH125AN3

SIZE	DWG NO.	REV
A4	BILCW03BZMH125AN3_01	1

FILE NAME BILCW03BZMH125AN3_01.PDF SHEET 1 OF 1