

**DRAWING DISCLAIMER**  
 COPYRIGHT OF THIS DRAWING IS RESERVED BY BIL GROUP LTD. IT IS ISSUED ON CONDITION THAT IT IS NOT REPRODUCED, COPIED, OR DISCLOSED TO A THIRD PARTY EITHER WHOLLY OR IN PART WITHOUT THE CONSENT IN WRITING OF BIL GROUP LTD.

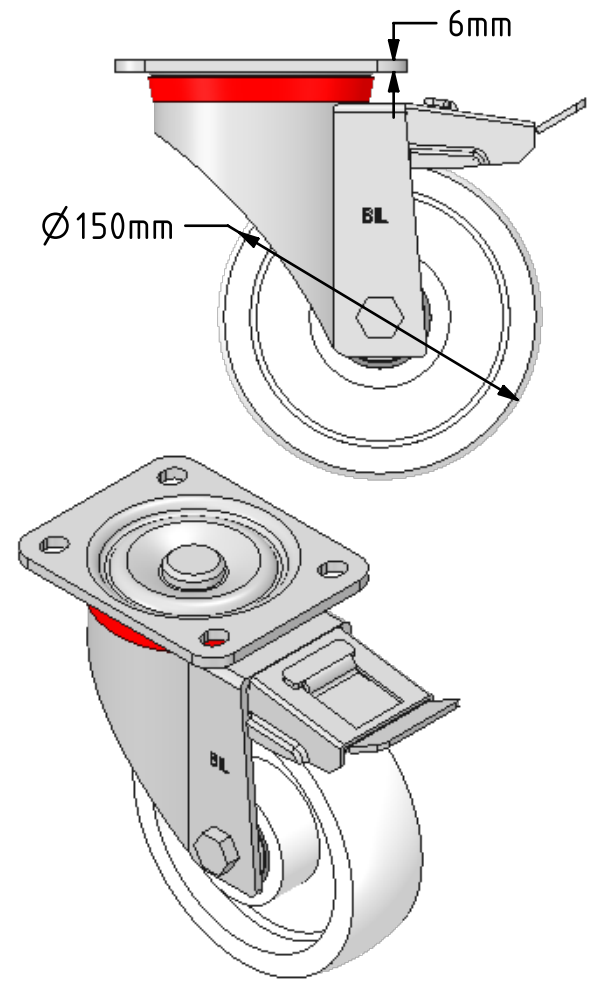

**Description:**  
 BZP150NYBJSWB  
 Pressed steel swivel castor with a top plate fixing fitted with a white nylon wheel, ball bearing and swivel wheel brake. Wheel diameter 150mm, tread width 45mm, overall height 194mm, plate size 135mm x 110mm, hole centres 105mm x 80mm. Load capacity 800kg.

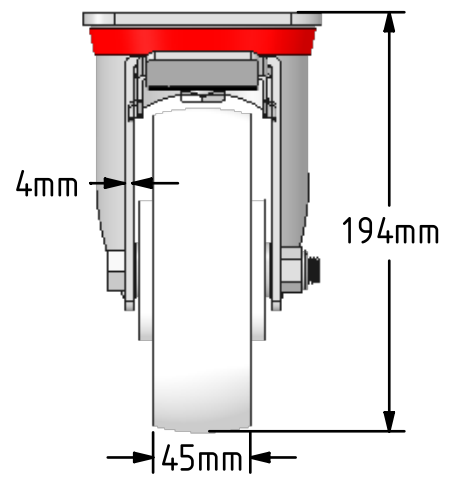
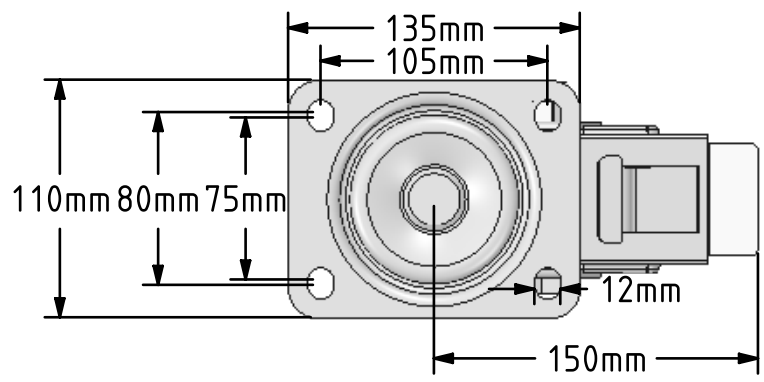

	NAME	DATE
DRAWN	Matt	01/02/18
APPROVED BY	Chris	01/02/18
SCALE	2:7	01/02/18
WEIGHT	3.157kg	01/02/18

**BIL** BIL Group Ltd, Porte Marsh Road, Calne  
 Wiltshire, SN11 9BW, United Kingdom  
 Tel +44 (0)1249 822 222 Fax: +44 (0)1249 822 300  
 www.bilgroup.co.uk

UNLESS OTHERWISE SPECIFIED DIMENSIONS ARE IN MILLIMETRES  
 Unspecified Tolerances  
 Machining ± 0.25mm  
 Fabrication ± 1mm

TITLE		REV
BZP150NYBJSWB		2
SIZE	DWG NO.	FILE NAME
A4	BILCW03BZP150NYBJSWB__02	BILCW03BZP150NYBJSWB__02.PDF
		SHEET 1 OF 1