

DRAWING DISCLAIMER
 COPYRIGHT OF THIS DRAWING IS RESERVED BY BIL GROUP LTD. IT IS ISSUED ON CONDITION THAT IT IS NOT REPRODUCED, COPIED, OR DISCLOSED TO A THIRD PARTY EITHER WHOLLY OR IN PART WITHOUT THE CONSENT IN WRITING OF BIL GROUP LTD.

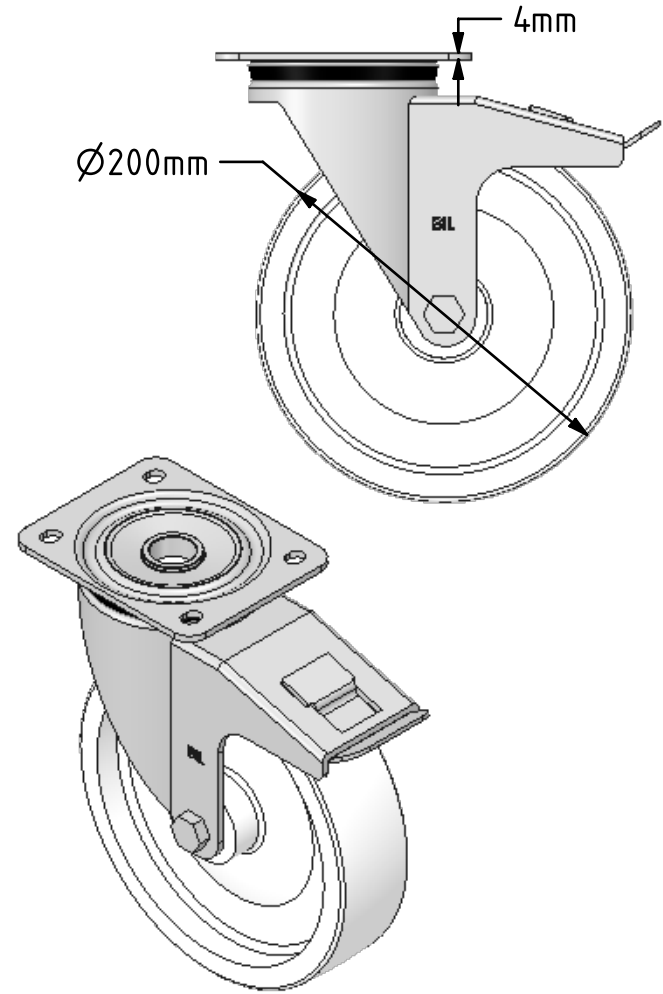

Description:
 BZPH200NYSWB
 Pressed steel swivel castor with a top plate fixing fitted with a white nylon wheel with plain bearings and total lock brake. Wheel diameter 200mm, tread width 50mm, overall height 238mm, top plate 135mm x 110mm, hole centres 105mm x 80/75mm. Load capacity 500kg.

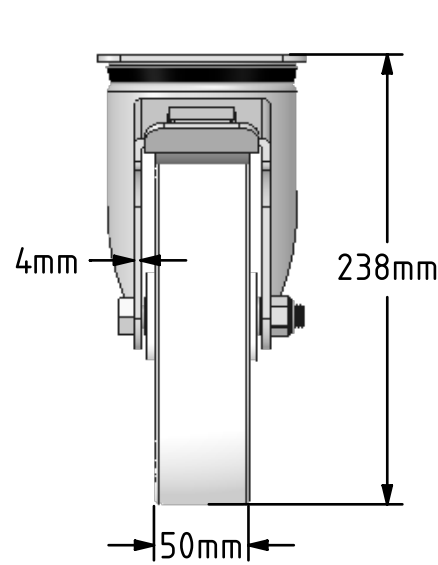
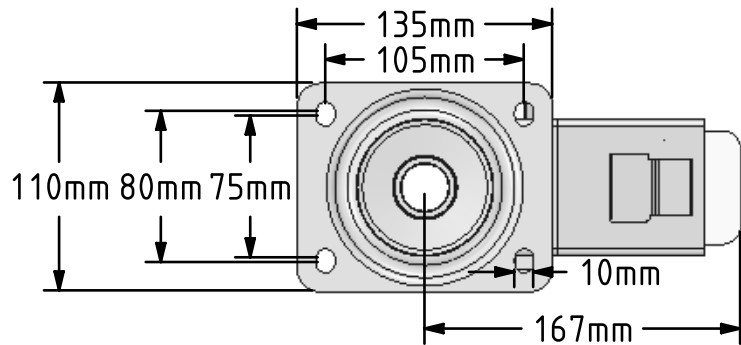

	NAME	DATE
DRAWN	Matt	17/07/18
APPROVED BY	Tim W	17/07/18
SCALE	1:4	17/07/18
WEIGHT	2.924kg	17/07/18

BIL Group Ltd, Porte Marsh Road, Calne
 Wiltshire, SN11 9BW, United Kingdom
 Tel +44 (0)1249 822 222 Fax: +44 (0)1249 822 300
 www.bilgroup.co.uk

UNLESS OTHERWISE SPECIFIED DIMENSIONS ARE IN MILLIMETRES
 Unspecified Tolerances
 Machining ± 0.25mm
 Fabrication ± 1mm

TITLE BZPH200NYSWB		
SIZE A4	DWG NO. BILCW03BZPH200NYSWB_01	REV 1
FILE NAME	BILCW03BZPH200NYSWB_01.PDF	SHEET 1 OF 1