

**DRAWING DISCLAIMER**  
 COPYRIGHT OF THIS DRAWING IS RESERVED BY BIL GROUP LTD. IT IS ISSUED ON CONDITION THAT IT IS NOT REPRODUCED, COPIED, OR DISCLOSED TO A THIRD PARTY EITHER WHOLLY OR IN PART WITHOUT THE CONSENT IN WRITING OF BIL GROUP LTD.

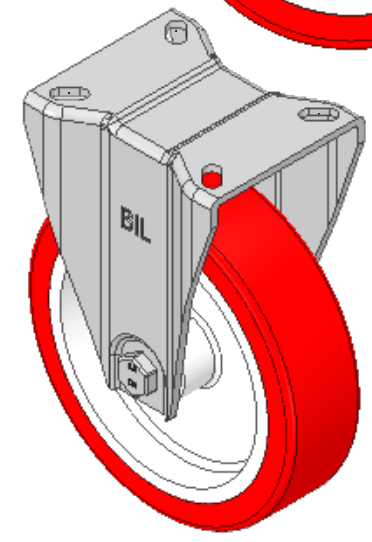

**Description:**  
 BZPHFL150NP  
 Pressed steel fixed castor with a top plate fixing fitted with a red polyurethane tyre white nylon centred wheel with plain bore. Wheel diameter 150mm, tread width 40mm, overall height 190mm, top plate 105mm x 85mm, hole centres 80mm x 60mm. Load capacity 350Kg.

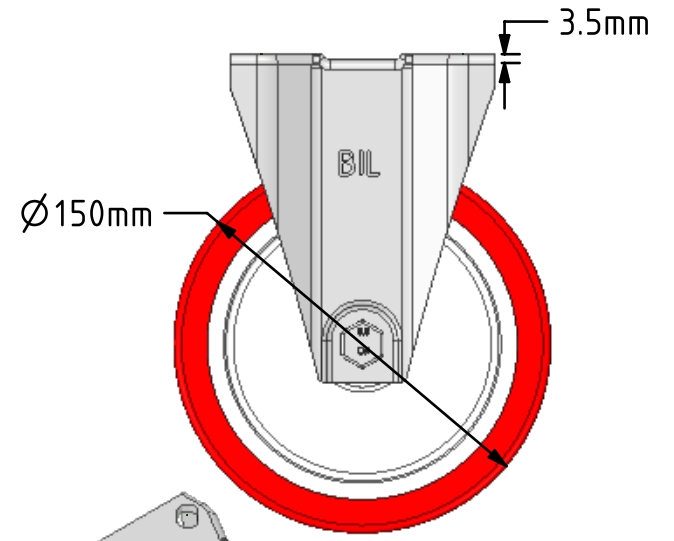
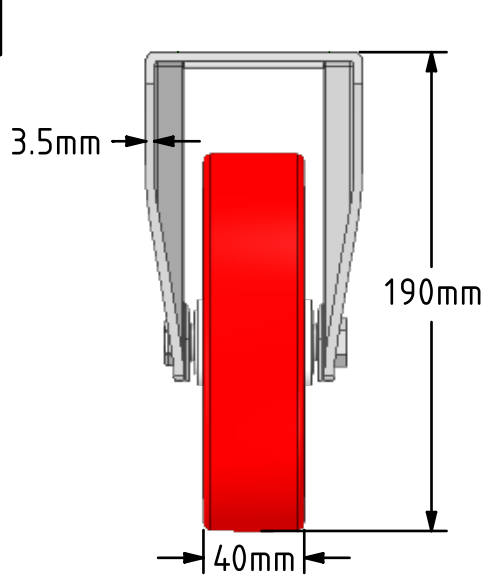
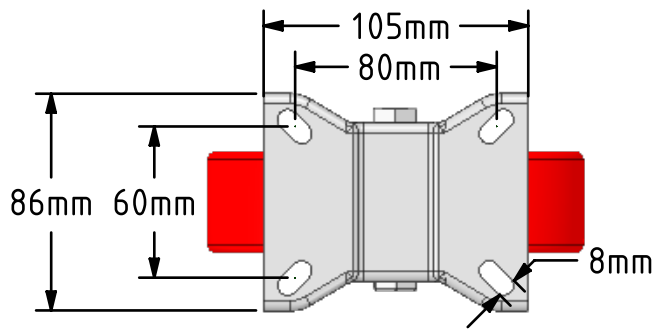

	NAME	DATE
DRAWN	Matt	08/04/19
APPROVED BY	Chris	08/04/19
SCALE	1:3	08/04/19
WEIGHT	1.235kg	08/04/19

 BIL Group Ltd, Porte Marsh Road, Calne  
 Wiltshire, SN11 9BW, United Kingdom  
 Tel +44 (0)1249 822 222 Fax: +44 (0)1249 822 300  
 www.bilgroup.co.uk

TITLE		REV
BZPHFL 150NP		2
SIZE	DWG NO.	FILE NAME
A4	BILCW03BZPHFL 150NP__02	BILCW03BZPHFL150NP__02.PDF
		SHEET 1 OF 1

UNLESS OTHERWISE SPECIFIED DIMENSIONS ARE IN MILLIMETRES  
 Unspecified Tolerances  
 Machining ± 0.25mm  
 Fabrication ± 1mm