

DRAWING DISCLAIMER  
 COPYRIGHT OF THIS DRAWING IS RESERVED BY BIL GROUP LTD. IT IS ISSUED ON CONDITION THAT IT IS NOT REPRODUCED, COPIED, OR DISCLOSED TO A THIRD PARTY EITHER WHOLLY OR IN PART WITHOUT THE CONSENT IN WRITING OF BIL GROUP LTD.

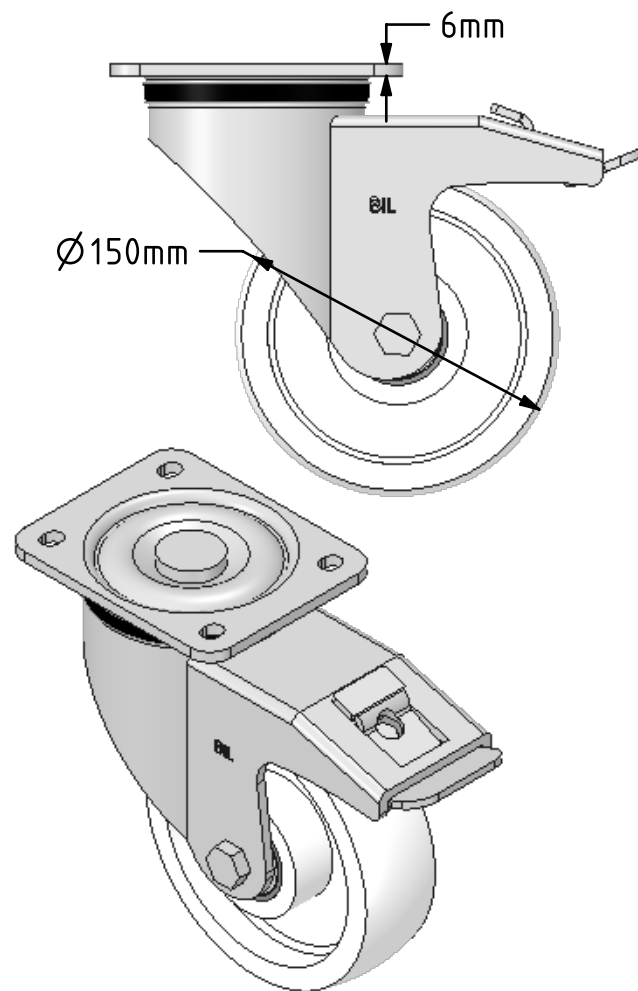

Description:  
 BZXP150NYBJSWB

Pressed steel swivel castor with a top plate fixing fitted with a white nylon wheel with ball bearings and a total lock brake. Wheel diameter 150mm, tread width 45mm, overall height 200mm, top plate 135mm x 110mm, hole centres 105mm x 80/75mm. Load capacity 800kg.

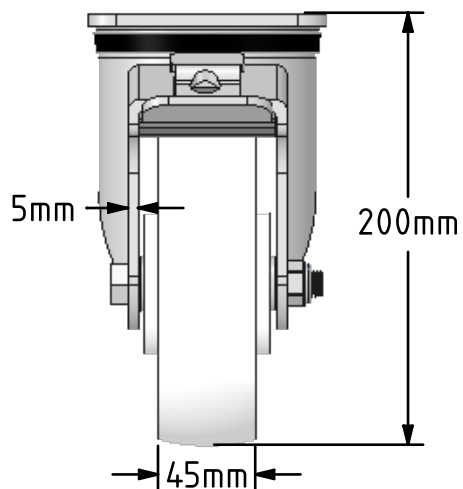
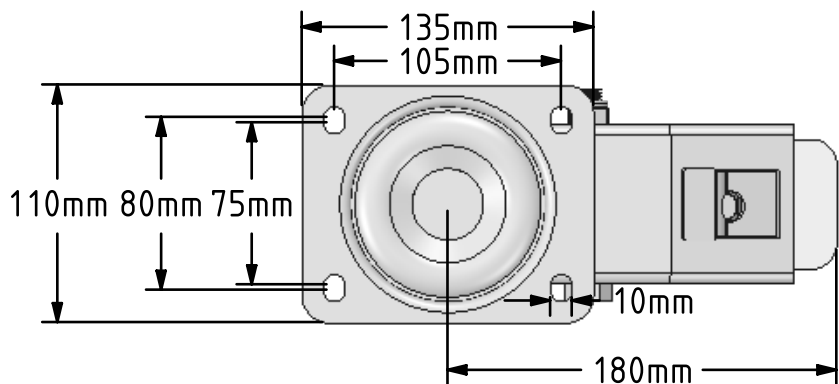

	NAME	DATE
DRAWN	Matt	26/02/18
APPROVED BY	Kevin	26/02/18
SCALE	2:7	26/02/18
WEIGHT	3.85kg	26/02/18

UNLESS OTHERWISE SPECIFIED DIMENSIONS ARE IN MILLIMETRES

Unspecified Tolerances  
 Machining ± 0.25mm  
 Fabrication ± 1mm



BIL Group Ltd, Porte Marsh Road, Calne  
 Wiltshire, SN11 9BW, United Kingdom  
 Tel +44 (0)1249 822 222 Fax: +44 (0)1249 822 300  
 www.bilgroup.co.uk

TITLE

BZXP150NYBJSWB

SIZE DWG NO.  
 A4 BILCW03BZXP150NYBJSWB\_01

REV  
 1

FILE NAME BILCW03BZXP150NYBJSWB\_01.PDF SHEET 1 OF 1