

ITEM NO.	PART NUMBER	QTY
1	BZMM100ASSWB	1
2	BZMM100WSRNRB	1
3	AXLE KIT	
	TUBEM12X40	1
	HEXBOLTM8X55Z8.8	1
	NYLOCM8Z	1

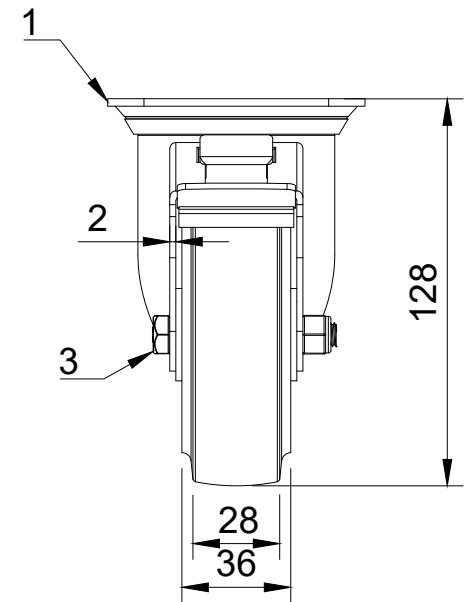

UNLESS OTHERWISE SPECIFIED DIMENSIONS ARE IN MILLIMETRES Unspecified Tolerances Machining ± 0.25mm Fabrication ± 1mm	DRAWING DISCLAIMER COPYRIGHT OF THIS DRAWING IS RESERVED BY BIL GROUP LTD. IT IS NOT REPRODUCED, COPIED, OR DISCLOSED TO A THIRD PARTY EITHER WHOLLY OR IN PART WITHOUT THE CONSENT IN WRITING OF BIL GROUP LTD	NAME Matt	DATE 04/04/24		BIL Group Ltd Porte Marsh Road Calne, Wiltshire, SN11 9BW United Kingdom Tel +44 (0)1249 822 222 www.bilgroup.co.uk
		DRAWN BY Matt	DATE 04/04/24		
		APPROVED BY Kevin	DATE 04/04/24	DWG NO. BZMM100SRNBSWB	REV 1
		SCALE 2:5		BZMM100SRNBSWB	
		WEIGHT 0.812kg		BZMM100SRNBSWB SHEET 1 OF 1	