

ITEM NO.	PART NUMBER	QTY
1	BZMM150ASBH16SWB	1
2	BZMH150WSRNBHM15	1
3	AXLE KIT	
	TH15X5X12	2
	HEXBOLTM12X90Z8.8	1
	NYLOCM12Z	1

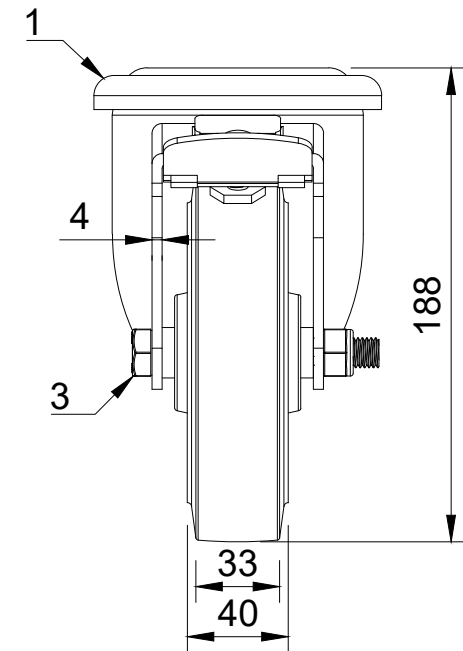

UNLESS OTHERWISE SPECIFIED DIMENSIONS ARE IN MILLIMETRES

Unspecified Tolerances
Machining ± 0.25mm
Fabrication ± 1mm

DRAWING DISCLAIMER

COPYRIGHT OF THIS DRAWING IS RESERVED BY BIL GROUP LTD. IT IS NOT REPRODUCED, COPIED, OR DISCLOSED TO A THIRD PARTY EITHER WHOLLY OR IN PART WITHOUT THE CONSENT IN WRITING OF BIL GROUP LTD

	NAME	DATE
DRAWN BY	Matt	16/10/24
APPROVED BY	Kevin	17/10/24
SCALE	1:3	
WEIGHT	2.523kg	

<p>BIL Group Ltd Porte Marsh Road Calne, Wiltshire, SN11 9BW United Kingdom Tel +44 (0)1249 822 222 www.bilgroup.co.uk</p>	<p>VARLEY</p>	<p>H Varley Ltd Unit 5 Century Park Pacific Rd, Broadheath, Atrincham, Cheshire WA14 5BJ Tel +44 (0)161 928 9617 www.varley-castors.co.uk</p>	DWG NO.	REV
			BZMM150SRNBJBH16SWB	1
BZMM150SRNBJBH16SWB			SHEET 1 OF 1	