

| ITEM NO. | PART NUMBER | QTY |
|----------|-------------------|-----|
| 1 | JAZ/M12 | 1 |
| 2 | BZH100PTBJBH12SWB | 1 |
| 3 | NM12JAZ | 1 |
| 4 | JAZ/BAR | 1 |

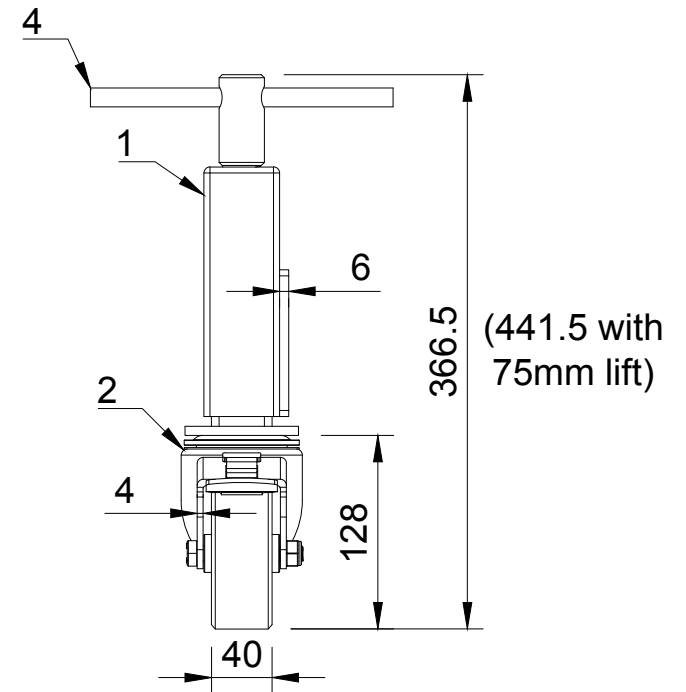

UNLESS OTHERWISE SPECIFIED DIMENSIONS ARE IN MILLIMETRES

Unspecified Tolerances
Machining ± 0.25mm
Fabrication ± 1mm

DRAWING DISCLAIMER

COPYRIGHT OF THIS DRAWING IS RESERVED BY BIL GROUP LTD. IT IS NOT REPRODUCED, COPIED, OR DISCLOSED TO A THIRD PARTY EITHER WHOLLY OR IN PART WITHOUT THE CONSENT IN WRITING OF BIL GROUP LTD

| | NAME | DATE |
|-------------|---------|----------|
| DRAWN BY | Matt | 10/03/25 |
| APPROVED BY | Kevin | 10/03/25 |
| SCALE | 1:5 | |
| WEIGHT | 4.865kg | |

| | | | |
|----------------------|---|--------------|---|
| | BIL Group Ltd Porte Marsh Road Calne, Wiltshire, SN11 9BW United Kingdom Tel +44 (0)1249 822 222 www.bilgroup.co.uk | | H Varley Ltd Unit 5 Century Park Pacific Rd, Broadheath, Altrincham, Cheshire WA14 5BJ Tel +44 (0)161 928 9617 www.varley-castors.co.uk |
| | DWG NO. JAZ100PTBJSWB | | REV 1 |
| JAZ100PTBJSWB | | SHEET 1 OF 1 | |