

ITEM NO.	PART NUMBER	QTY
1	JAZXXH	1
2	BZQX250PTBJ	1
3	FITTINGS	
	WM16X30X3Z	8
	BOLTM16X65	4
	NM16MYTHINZ	4

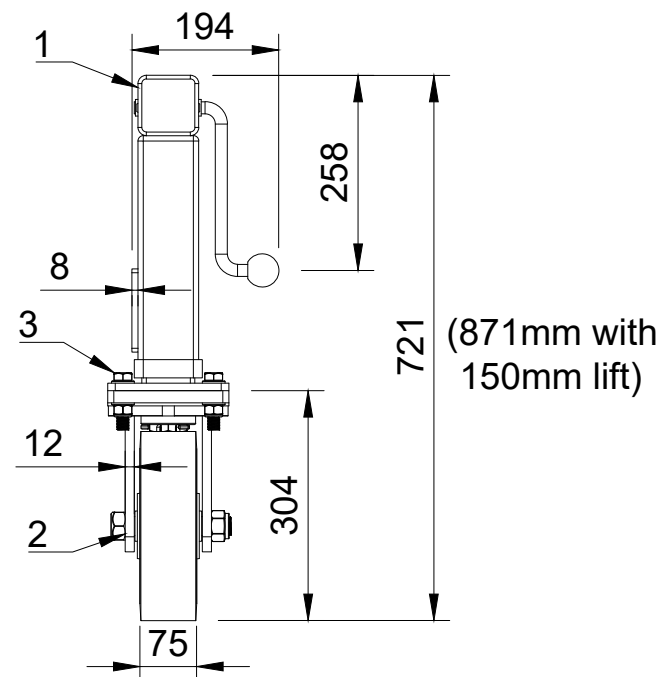

UNLESS OTHERWISE SPECIFIED DIMENSIONS ARE IN MILLIMETRES

Unspecified Tolerances  
Machining  $\pm 0.25\text{mm}$   
Fabrication  $\pm 1\text{mm}$

#### DRAWING DISCLAIMER

COPYRIGHT OF THIS DRAWING IS RESERVED BY BIL GROUP LTD. IT IS NOT REPRODUCED, COPIED, OR DISCLOSED TO A THIRD PARTY EITHER WHOLLY OR IN PART WITHOUT THE CONSENT IN WRITING OF BIL GROUP LTD

	NAME	DATE
DRAWN BY	Matt	23/07/24
APPROVED BY	Kevin	23/07/24
SCALE	1:10	
WEIGHT	33.427kg	

BIL Group Ltd Porte Marsh Road Calne, Wiltshire, SN11 9BW United Kingdom Tel +44 (0)1249 822 222 www.bilgroup.co.uk		  H Varley Ltd Unit 5 Century Park Pacific Rd, Broadheath, Altrincham, Cheshire WA14 5BJ Tel +44 (0)161 928 9617 www.varley-castors.co.uk	
DWG NO.		JAZHD250PTBJ	REV 1
JAZHD250PTBJ		SHEET 1 OF 1	