

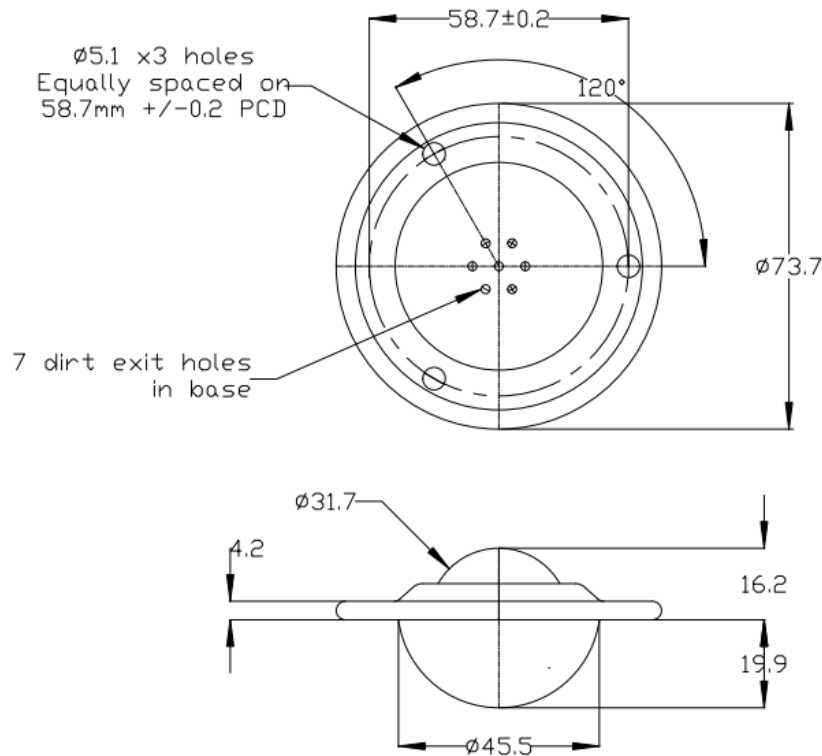

10221500 DATASHEET



PART No.	BALL SIZE (mm)	WEIGHT (kgs)	FLANGE DIAMETER (mm)	WORKING HEIGHT OF BALL (mm)	FLANGE THICKNESS (mm)	HOLE SIZE (mm)	HOLE CENTRES PCD (mm)
10221500	Ø31.7	0.265	Ø73.7	16.2	4.2	Ø5.1	58.7 +/- 0.2

MAXIMUM DYNAMIC LOADING

Type 15 with stainless steel load ball and body - 125kgs ball up

MATERIALS

Body - Stainless steel AISI304 with self colour finish

Balls – Stainless steel AISI420C with hardness of 52 – 58HRC self colour finish

Seal – Woollen felt

KEY FEATURES

Low profile

x3 fixing holes in flange for securing unit

Unit assembled with a felt seal

7 dirt exit holes in base of unit for removal of dirt

Operating temperature 70°C continuous to 100°C maximum