

11MIO513 DATASHEET

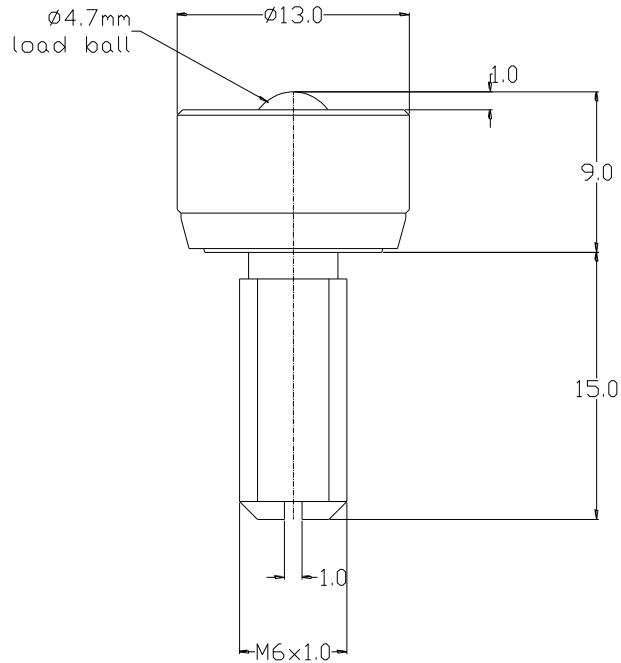

REF No.	BALL SIZE (mm)	WEIGHT (kgs)	MAXIMUM DIAMETER (mm)	WORKING HEIGHT OF BALL (mm)	BALL EXPOSURE ABOVE OUTER RING (mm)	THREAD SIZE	THREAD LENGTH (mm)
11MIO513	Ø4.7	0.01	Ø13.0	9.0	1.0	M6 x 1.0	15.0

MAXIMUM DYNAMIC LOADING

Type 13 Stainless steel body and chrome steel balls 10kgs ball up

MATERIALS

Body and M6 screw thread – BS970 416 S21 stainless steel with self colour finish

Balls - Chrome steel AISI52100 hardened to 60 – 62HRC with self colour finish

Outer ring – EN1A steel with zinc plated finish

KEY FEATURES

Small size

M6 screw thread fixing

MAXIMUM OPERATING TEMPERATURE

100°C