

## 11MI0515 DATASHEET

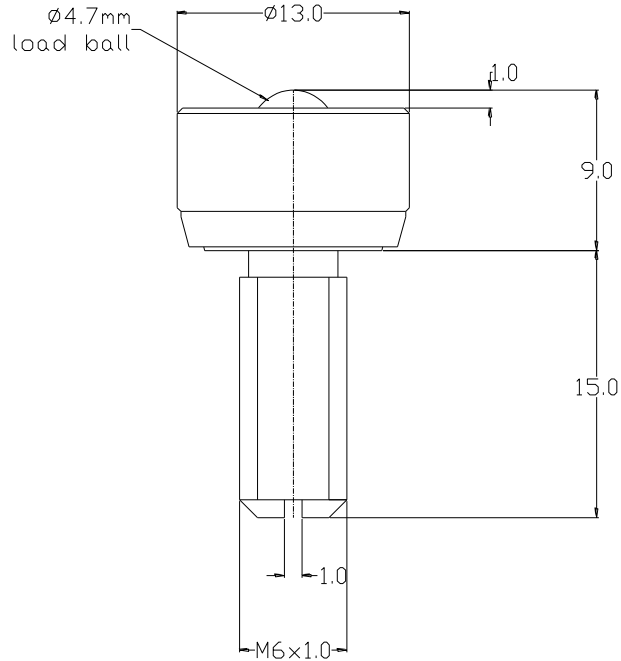

REF No.	BALL SIZE (mm)	WEIGHT (kgs)	MAXIMUM DIAMETER (mm)	WORKING HEIGHT OF BALL (mm)	BALL EXPOSURE ABOVE OUTER RING (mm)	THREAD SIZE	THREAD LENGTH (mm)
11MI0515	Ø4.7	0.01	Ø13.0	9.0	1.0	M6 x 1.0	15.0

### MAXIMUM DYNAMIC LOADING

Type 15 Stainless steel body and balls 10kgs ball up

### MATERIALS

Body and M6 screw thread – BS970 416 S21 stainless steel with self colour finish

Balls - Stainless steel AISI420C hardened to 52 – 58HRC with self colour finish

Outer ring – Stainless steel AISI303 with self colour finish

### KEY FEATURES

Small size

M6 screw thread fixing

### MAXIMUM OPERATING TEMPERATURE

100°C