

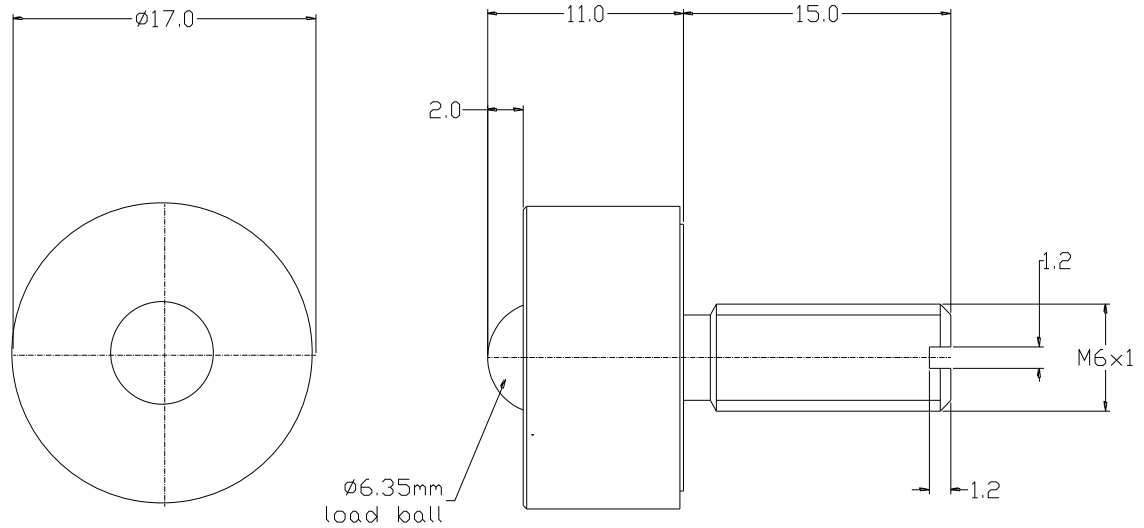

## 11MI0615 DATASHEET



PART No.	BALL SIZE (mm)	WEIGHT (Kgs)	MAXIMUM DIAMETER (mm)	WORKING HEIGHT OF BALL (mm)	BALL EXPOSURE ABOVE OUTER RING (mm)	THREAD SIZE	OVERALL LENGTH (mm)
11MI0615	Ø6.3	0.02	Ø17.0	11.0	2.0	M6x1	26.0

### MAXIMUM DYNAMIC LOADING – BALL UP

Type 15 Stainless steel body and bearings 20kgs

### MATERIALS

Body and screw thread – AISI416 stainless steel with self colour finish

Outer ring – AISI303 stainless steel with self colour finish

Balls - Stainless steel AISI420 with hardness of 52 – 58HRC and self colour finish

### KEY FEATURES

Body and screw thread are precision CNC machined in one piece

M6 by 15mm long screw thread fixing with screw driver slot

Stainless steel body and small balls offers good corrosion resistance

Maximum operating temperature +200°C with 50% reduction in load rating