

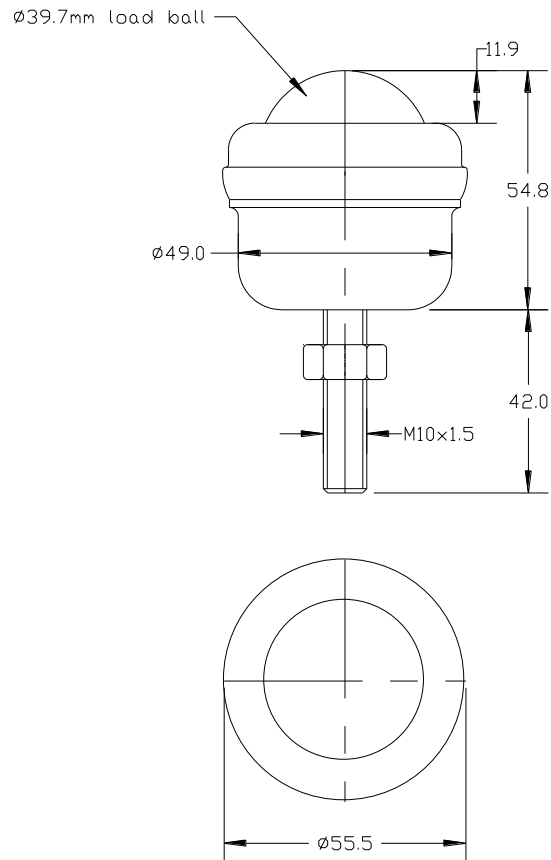

20051342 DATASHEET



PART No.	BALL SIZE (mm)	WEIGHT (Kgs)	MAXIMUM DIAMETER (mm)	WORKING HEIGHT OF BALL (mm)	BALL EXPOSURE ABOVE OUTER RING (mm)	BODY DIAMETER (mm)	THREAD SIZE (mm)	THREAD LENGTH (mm)
20051342	Ø39.7	0.46	Ø55.5	54.8	11.9	Ø49	M10x1.5	42

MAXIMUM DYNAMIC LOADING

Type 13 Carbon steel bearings 140kgs ball up, 60kgs ball down

MATERIALS

Body – Carbon steel with BZP finish

M10x1.5mm screw thread – Carbon steel with BZP finish

Balls – AISI52100 chrome steel with hardness of 60 – 65HRC and self colour finish

Seal – Woollen felt oiled with ISO68 oil

KEY FEATURES

M10x1.5mm screw thread for easy single hole fixing

Maximum tightening torque on nut 20Nm

Maximum operating temperature of 70°C continuous to 100°C intermittent