

8004513 DATASHEET

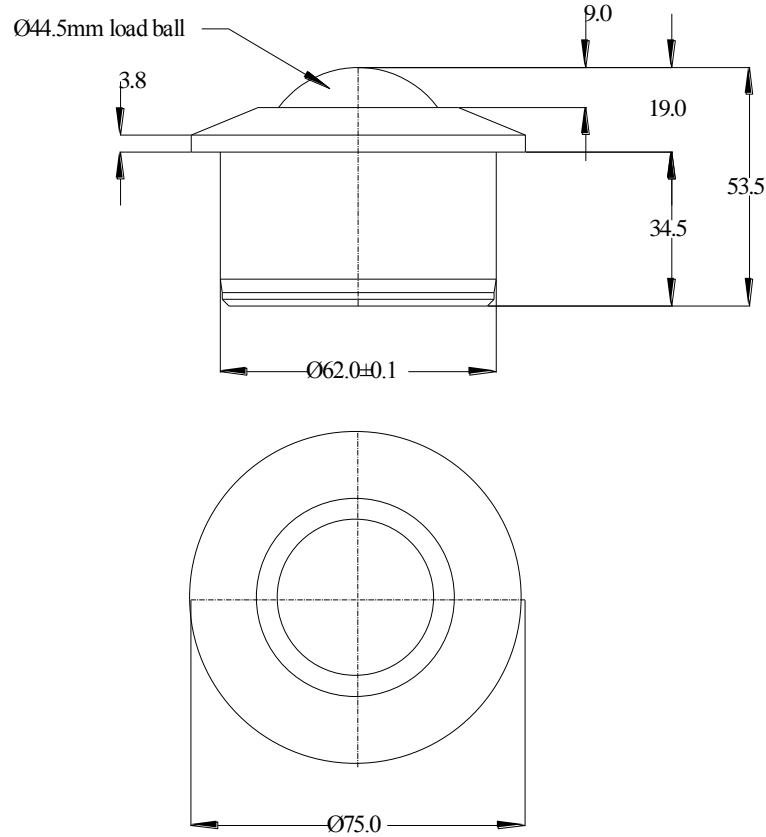

PART No.	BALL SIZE (mm)	WEIGHT (Kgs)	MAXIMUM DIAMETER (mm)	WORKING HEIGHT OF BALL (mm)	BALL EXPOSURE ABOVE OUTER RING (mm)	BODY DIAMETER (mm)	FLANGE THICKNESS (mm)	OVERALL HEIGHT (mm)
8004513	Ø44.5	1.1	Ø75.0	19.0	9.0	Ø62.0 + - 0.1	3.8	53.5

MAXIMUM DYNAMIC LOADING – BALL UP

Type 13 Carbon Steel Bearings 600Kg

MATERIALS

Body - Carbon steel with zinc plated finish

Balls - Carbon steel with hardness of 60HRC and self colour finish

Seal - Woollen felt seal

KEY FEATURES

Single dirt exit hole

Low profile

Strong solid steel body construction