

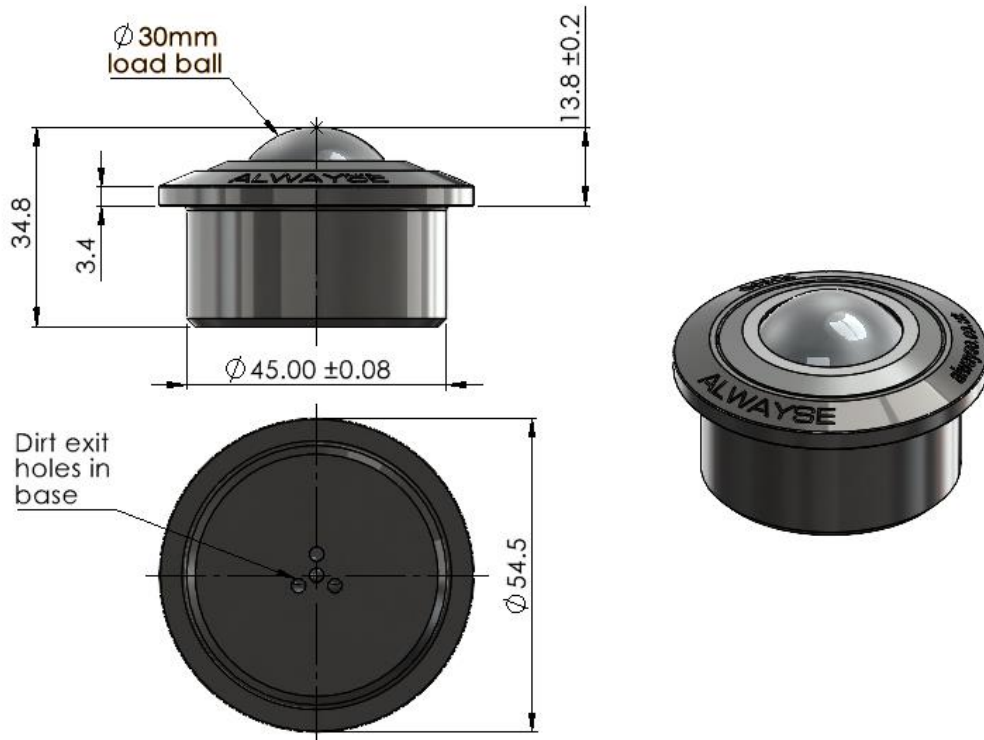

DO NOT SEND THIS DATASHEET  
TO A CUSTOMER UNTIL IT IS  
APPROVED

8053016 NEW DATASHEET



PART No.	BALL SIZE (mm)	WEIGHT (kgs)	FLANGE DIAMETER (mm)	WORKING HEIGHT OF BALL (mm)	BODY DIAMETER (mm)	FLANGE THICKNESS (mm)	OVERALL HEIGHT (mm)
8053016 NEW	Ø30	0.341	Ø54.5	13.8 +/- 0.2	Ø45 +/- 0.08	3.4	34.8

**MAXIMUM DYNAMIC LOADING –**

Type 16 Carbon steel body and stainless steel bearings 350kgs ball up

**MATERIALS**

Body - Carbon steel with zinc plated finish

Outer ring – Carbon steel with zinc plated finish

Balls - Stainless steel AISI420C with hardness of 52 – 58HRC and self colour finish

**KEY FEATURES**

Strong solid steel construction

Multi-dirt exit holes in bottom of body for removal of dirt/debris

New design with reduced noise of 64dB and weight

Maximum operating temperature 70 C continuous or 100 C intermittent